

Knocker Spark Gap Adjustment

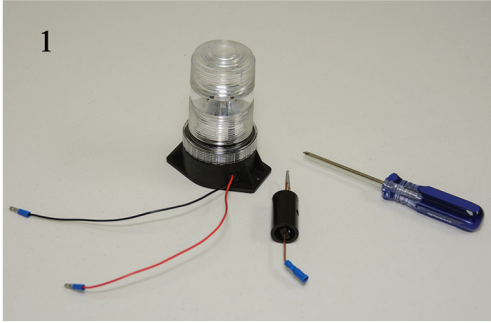

1
You will need a Phillips screw driver.

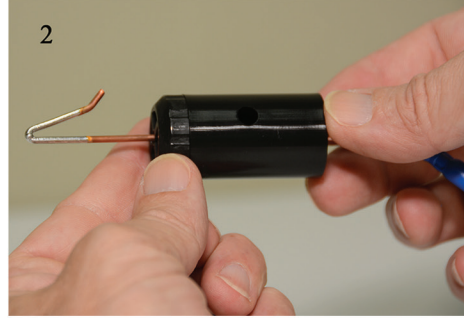

2
Hold Knocker with both hands.

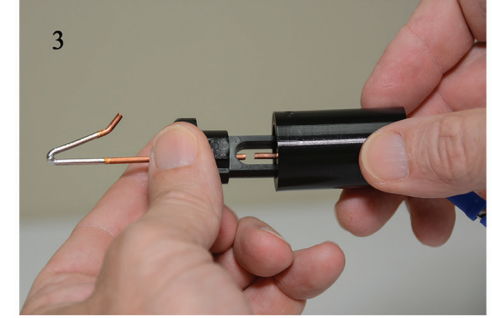

3
Rotate lower portion of Knocker counter clock wise and slide the Knocker down and out of your way.

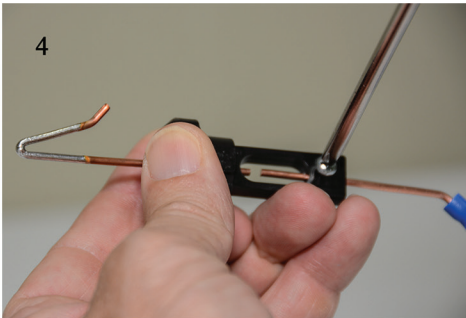

4
Loosen the small screw just enough so you can move the electrode in and out.

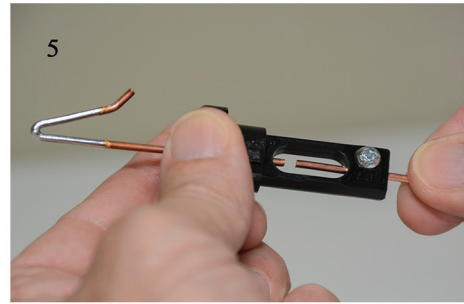

5
Adjust the spark gap between the electrodes wider until it stops arcing. Then keep readjusting the gap smaller until the light begins to flash. The main thing to remember is "the wider the gap the less it draws off the fence".

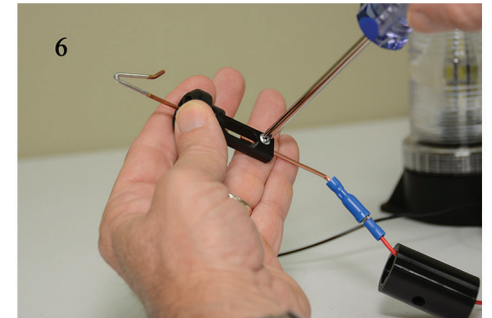

6
Tighten the screw.

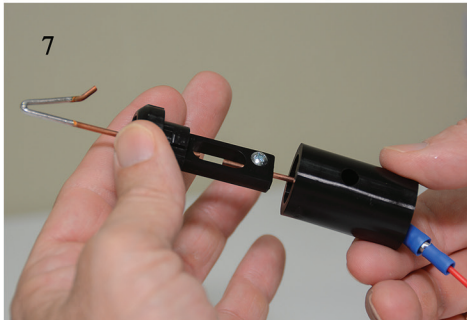

7
Place the lower portion of the Knocker back into position and rotate clock wise to lock into place.

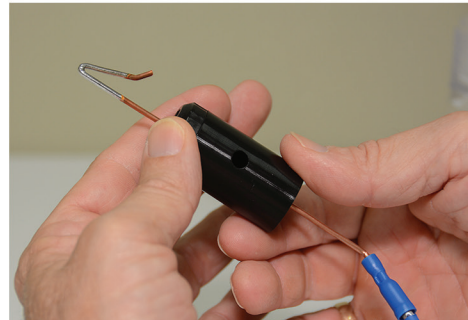

8
Connect the Knocker and Light together if it is not already connected.

(9) Mount the Light on top of your wooden post or T-Post (mounting brackets for T-Post sold separately). Hang the Knocker on to your electric fence and ensure that the ground wire is attached to the ground stake.

Phone Support: 615-476-6128 or e-mail: info@electricfencelight.com